

Whole application overview

Upload

Period Finding

*Button will appears only
when raw data is loaded*

This Area will show the:
upload input
or
Phase Finding
or
Results

Period Finding Layout: *before periodogram*

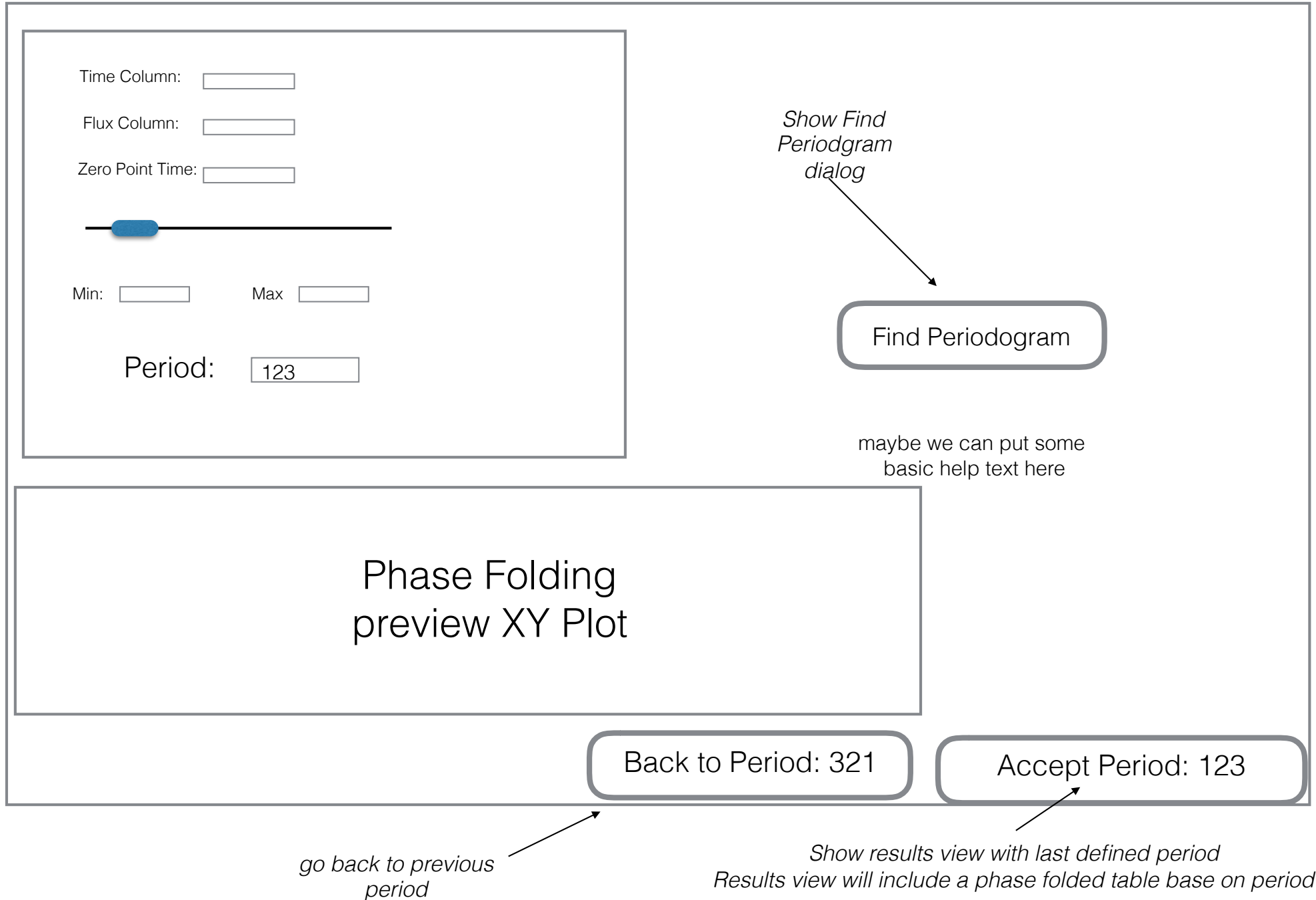

Period Finding Layout: *after periodogram*

Flux Column:

Zero Point Time:



Max

Period:

Table - Tabs: Peak,Periodogram

Phase Folding
preview XY Plot

Periodogram XY Plot &
Peak XY Plot

xyplot changes with table

Change Periodogram

Revert to Period: 123

Accept Period: 456

*Show Find
Periodogram
dialog*

*go back to previous
period*

*Show results view with last defined period
Results view will include a phase folded table base on period*

Find Periodogram Dialog

Algorithm:	<input type="text" value="—"/>
Time Column:	<input type="text"/>
Flux Column:	<input type="text"/>
Step Method:	<input type="text" value="—"/>
Step Size:	<input type="text"/>
Max Period:	<input type="text"/>
Min Period:	<input type="text"/>
Number of Peaks:	<input type="text"/>

Notes

- Layout of fields needs thought
- Submit: calls server for periodogram then updates Period Finding display

Result Layout

Image vis toolbar

Download

Table - with raw and phase folded

Cutout size:

Error column:

Phase XY Plot

Images



Questions:

- Should the images be on top?
- Should most of the space be given to images
- how big does the phase xy plot need to be?
- Is the primary interaction between the xyplots and images
- What are the major task the tables will be used for here

Light Curve App Flow

